

F1: FRAME

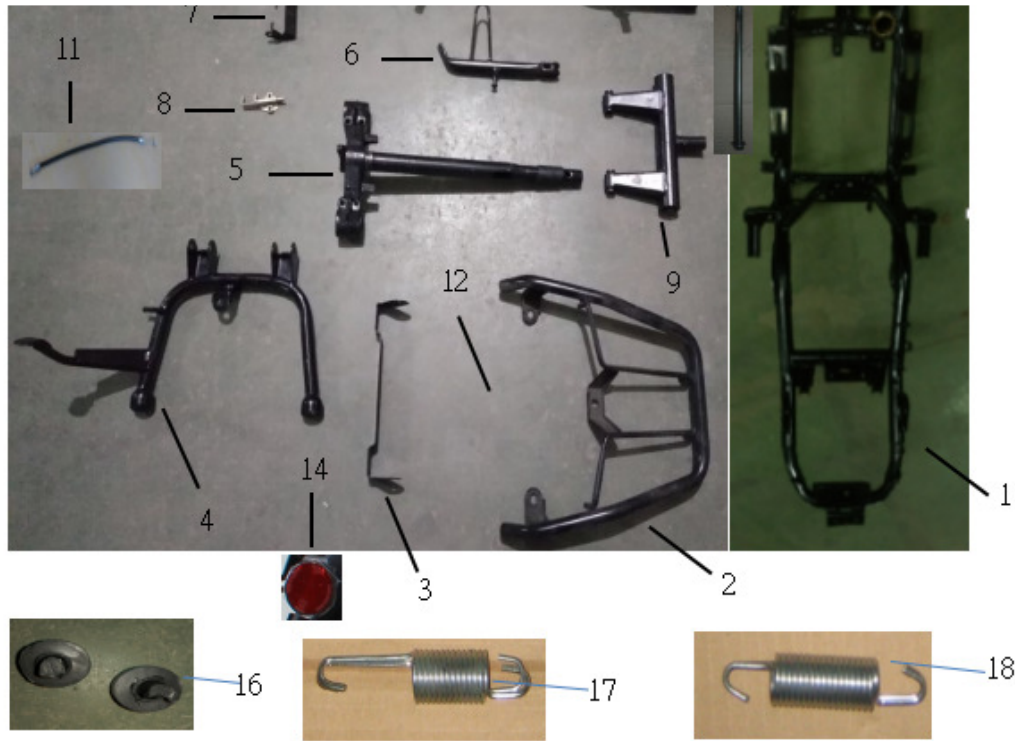

| No |
|----|
| 1 |
| 2 |
| 3 |



| |
|----|
| 4 |
| 5 |
| 6 |
| 7 |
| 8 |
| 9 |
| 10 |
| 11 |
| 12 |
| 13 |
| 14 |
| 15 |
| 16 |
| 17 |
| 18 |
| |
| |

F3: PLASTIC PARTS-2



18



19



20

No

1

2

3

4

5

6

7

8

9

10

11

12

13

14

15

16

17

18

19

20

F4: SHOCK ABSORBER

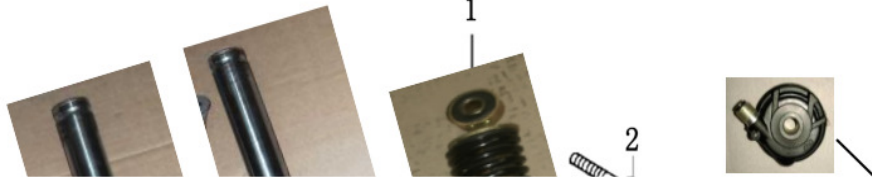

| No |
|----|
| 1 |
| 2 |
| 3 |
| 4 |
| 5 |

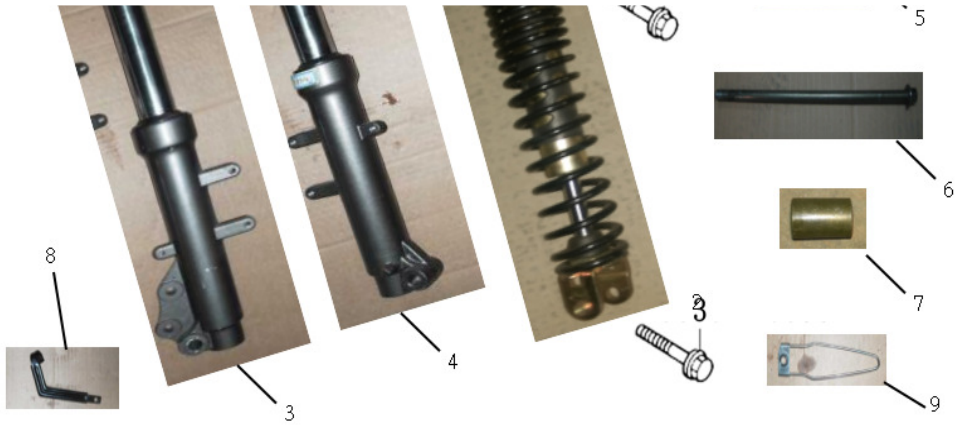

| |
|---|
| 6 |
| 7 |
| 8 |
| 9 |
| |
| |
| |
| |
| |
| |

F6: FUEL TANK



| No |
|----|
| 1 |
| 2 |
| 3 |
| 4 |
| 5 |
| 6 |
| 7 |
| 8 |
| 9 |
| 10 |
| |
| |
| |
| |

F8: LOCK



1



3



5



7



2



4



6



8



9



10



11



12



13



14



15



16



17

| No |
|----|
| 1 |
| 2 |
| 3 |
| 4 |
| 5 |
| 6 |
| 7 |
| 8 |
| 9 |
| 10 |
| 11 |
| 12 |
| 13 |
| 14 |
| 15 |
| 16 |
| 17 |

F9: ENGINE AND ELECTRIC PARTS



1



2



3



4



5



6



7



8



9



11



13



10



12



14

No

1

2

3

4

5

6

7

8

9

10

11

12

13

14

F10: ENGINE AND ELECTRIC PARTS

No



1

2

3

4

5

6

7

8

9

| Part No | Description |
|----------------------|--------------------|
| 50100-AEA1-0000/50cc | FRAME BODY |
| 8121-AEA1-0000-J | REAR-HANDRAIL |
| 84701-AEA1-0000-J | BRKT NUMBER PLATE |

| | |
|----------------------|----------------------|
| 5050A-AEA1-0000/50cc | STAND ASSY MAIN |
| 53200-AEA1-0000-J | STEERING STEM |
| 50530-AEA1-0000-J | BAR SIDE STAND |
| 77230-AEA1-0000-J | LOCK BASE OF SEAT |
| 77235-AEA1-0000-J | LOCK BASE OF SEAT |
| 50350-AEA1-0000/50cc | HANGER OF ENGINE |
| 53100-AEA1-0000-J | HANDLE BAR |
| 77240-AEA1-0000-J | CABLE OF SEAT LOCK |
| 8221-AEA1-0000-J | RUBBER,REAR-HANDRAIL |
| 77210-AEA1-0000 | SEAT PIN |
| 33742-ACB1-0000-J | FRONT REFLECTOR |
| 90117-AEA1-0050 | Hanger shaft |
| 50515-AEA1-0000-J | engine hanger plug |
| 95014-AEA1-0000-J | SPRING OF SIDE STAND |
| 50550-GT10-0000 | SPRING OF MAIN STAND |
| | |
| | |
| | |

| Part No | Description |
|-----------------|----------------|
| 53205-AEA1-0000 | STAY FENDER RR |
| 61100-AEA1-0000 | FRONT FENDER |
| 83500-AEA1-0000 | COVER R BODY |
| 83600-AEA1-0000 | COVER L BODY |
| 64302-AEA1-0000 | FRONT COVER |
| | |
| | |
| | |
| | |
| | |
| | |
| *NOTE* | |
| COLOR CODES | |
| RED | JJ001 |
| BLACK | JJ005 |
| BLUE | JJ0027 |
| COPPER | JJ030 |
| SLIVER | JJ036 |

| Part No | Description |
|-------------------|---------------------------|
| 81260-AEA1-0000-J | LUGGAGE BOX ASSY |
| 53208-AEA1-0000-J | DECORATED BOARD FR HANDLE |
| 81251-AEA1-0000-J | LID CARB MAINT |
| 50613-AEA1-0000-J | COVER UNDER |
| 80151-AEA1-0000-J | COVER CENTER |
| 80100-MT10-0000-J | FENDER RR TIRE |
| 81132-AEA1-0000-J | LEG SHIELD-BELOW |
| 50326-AEA1-0000-J | BATTERY COVER |
| 81131-AEA1-0000-J | LEG SHIELD-TOP |
| 80105-AEA1-0000-J | REAR FENDER COVER |
| 83750-AEA1-0000-J | TOP COVER,FUEL TANK |
| 53206-AEA1-0000-J | COVER RR HANDLE |
| 80109-AEA1-9300-J | REAR FENDER |
| 80150-AEA1-0000-J | WATER-BLOCKING PARTS |
| 64310-AEA1-0000-J | FLOOR PANEL |
| 64220-AEA1-0000-J | WIND SCREEN |
| 61110-ABEC-0000-J | FRONT FENDER EXTEND PLATE |
| 81134-AEA1-0000-J | HOOK LUGGAGE |
| 80152-AEA1-0000-J | CLIP ASSY CENTER |
| 81133-AEA1-0000-J | VIN PLASTIC COVER |
| | |
| | |

| Part No | Description |
|----------------------|-------------------------------|
| 52400-AEA1-0000/50cc | RR.SHOCK ABSORBER ASSY. |
| 95701-08030-000 | FLANGE BOLT M10×40 |
| 51500-GP10-0000-J | L.FR.FORK ASSY. |
| 51400-GP10-0000-J | R.FR.FORK ASSY. |
| 44800-AEA1-0000-J | GEAR BOX ASSY FOR CALCULATE S |

| Part No | Description |
|-------------------|---------------------|
| 17501-AEA1-0000 | FUEL TANK |
| 3780A-AEA1-0000-J | FUEL SENSOR ASSY |
| 17502-AEA1-0000 | FUEL TANK CAP |
| 16950-AEA1-0000 | AUTO COCK ASSY FUEL |
| 16910-F8-9000-J | STRAINER ASSY FUEL |
| 16911-AEA1-0000 | FUEL TUBE A |
| 16914-AEA1-0000 | FUEL TUBE D |
| 17550-AEA1-0000 | Carbon tank |
| 17560-AEA1-0000 | Dumping valve |
| 77200-AEA1-0000 | SEAT |
| | |
| | |
| | |
| | |

| Part No | Description |
|-------------------|-------------------------|
| 88120-AEA1-0000-J | MIRROR ASSY L/R BACK |
| 3520B-AEA1-0000 | Throttle block |
| 53166-AEA1-0000-J | L.GRIP,HANDLE |
| 53140-AEA1-0000-J | THROTTLE GRIP,HANDLE |
| 17910-AEA1-0000-J | THROTTLE CABLE |
| 44831-AEA1-0000-J | MILEAGE CABLE |
| 35101-AEA1-0000-J | MAIN LOCK ASSY |
| 35110-AEA1-0000 | Seat lock brackct |
| 35120-AEA1-0000 | Seat lock |
| 35130-AEA1-0000 | Seat lock |
| 53221-AEA1-0000-J | BOWL 2 |
| 53222-AEA1-0000-J | BOWL 2 |
| 53224-AEA1-0000-J | BOWL 3 |
| 53220-AEA1-0000-J | BALL ASSY.,down |
| 53223-AEA1-0000-J | BALL ASSY.,UPPER |
| 50305-AEA1-0000-J | TOP NUT,STEERING STEM A |
| 50306-AEA1-0000-J | TOP NUT,STEERING STEM B |

| Part No | Description |
|----------------------|----------------------------|
| 10000-SQ5A-9000-CCJ | ENGINE ASSEMBLY |
| 32100-AEA1-0000/50cc | NAIN WIRE HARNESS |
| Carburetor-1-J | CARBURETOR |
| 31600-AEA1-0000-J | RECTIFIER |
| 30510-AEA1-0000-J | IGNITION COIL COMP |
| 17200-AEA1-0000-J | AIR FIL TER |
| 38110-XF-9000-J | HORN |
| 38300-AEA1-0000-J | FLASHER |
| 30410-DGW-E000-J | CDI |
| 35805-AEA1-0000-J | START RELAY |
| 31500-AEA1-0000-J | BATTERY YB/BL- A/INPORT |
| 89000-AEA1-0000 | USER MANUELS |
| 89020-AEA1-0000 | caution stickers |
| 89010-AEA1-0000 | DRIVER'S TOOLS |
| | |
| | |
| | |
| | |
| | |
| | |

SPEED